

ACTIONMOBIL

SPEZIALFAHRZEUGE FÜR FERNREISEN, EXPEDITION UND WISSENSCHAFT

GLOBECRUISER 6500

















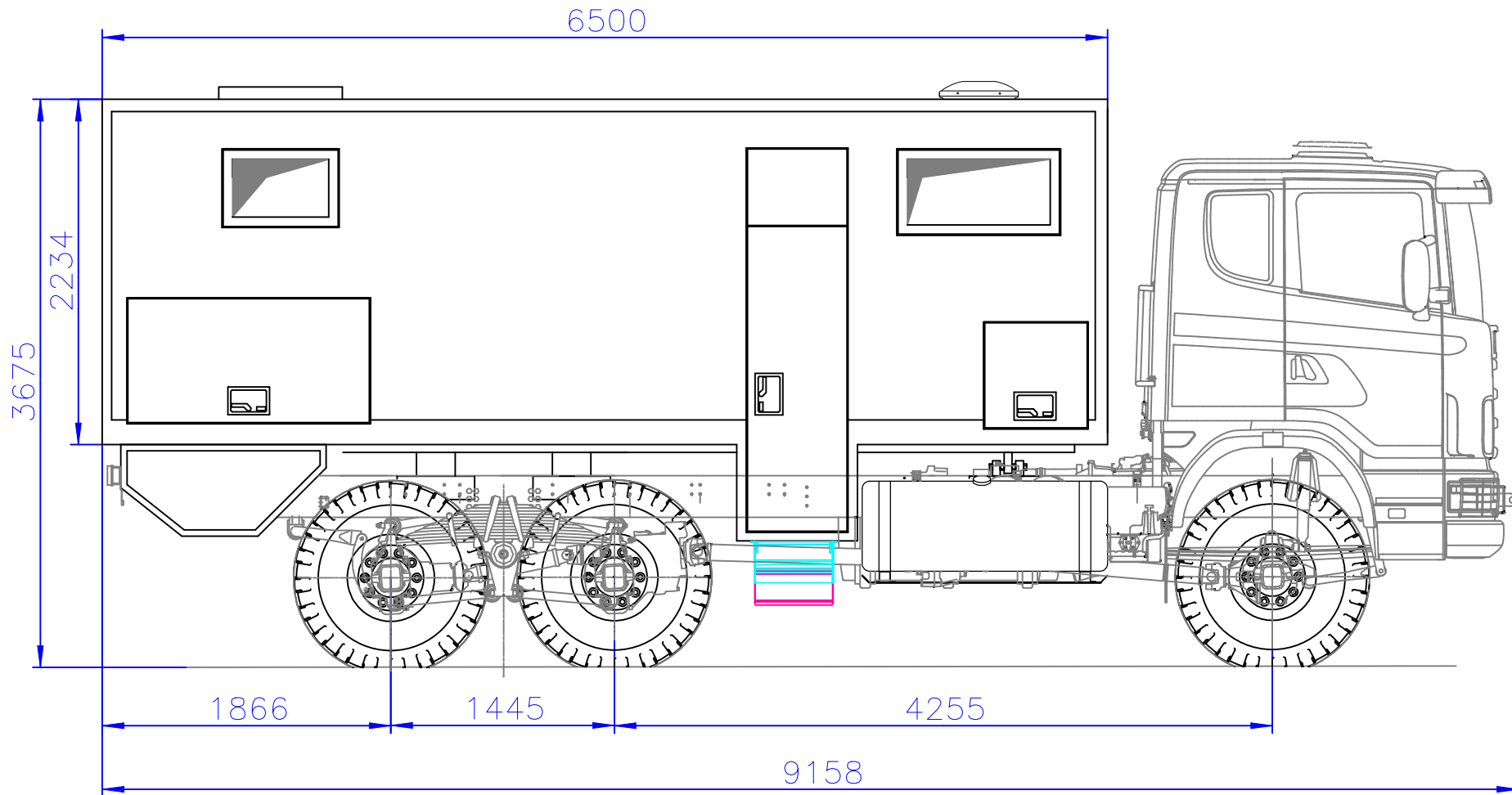

| | | |
|---------------------|----------------|------|
| Projekt | | |
| ÖSÜ ÖÒÒÛWQIÒÜÁ Í €€ | | |
| Bauteil | | |
| Außenseite | | |
| Ansicht | | |
| rechte Außenansicht | | |
| Maßstab | Index: | Pos. |
| 1:40 | 0 (11.08.2008) | S2a |

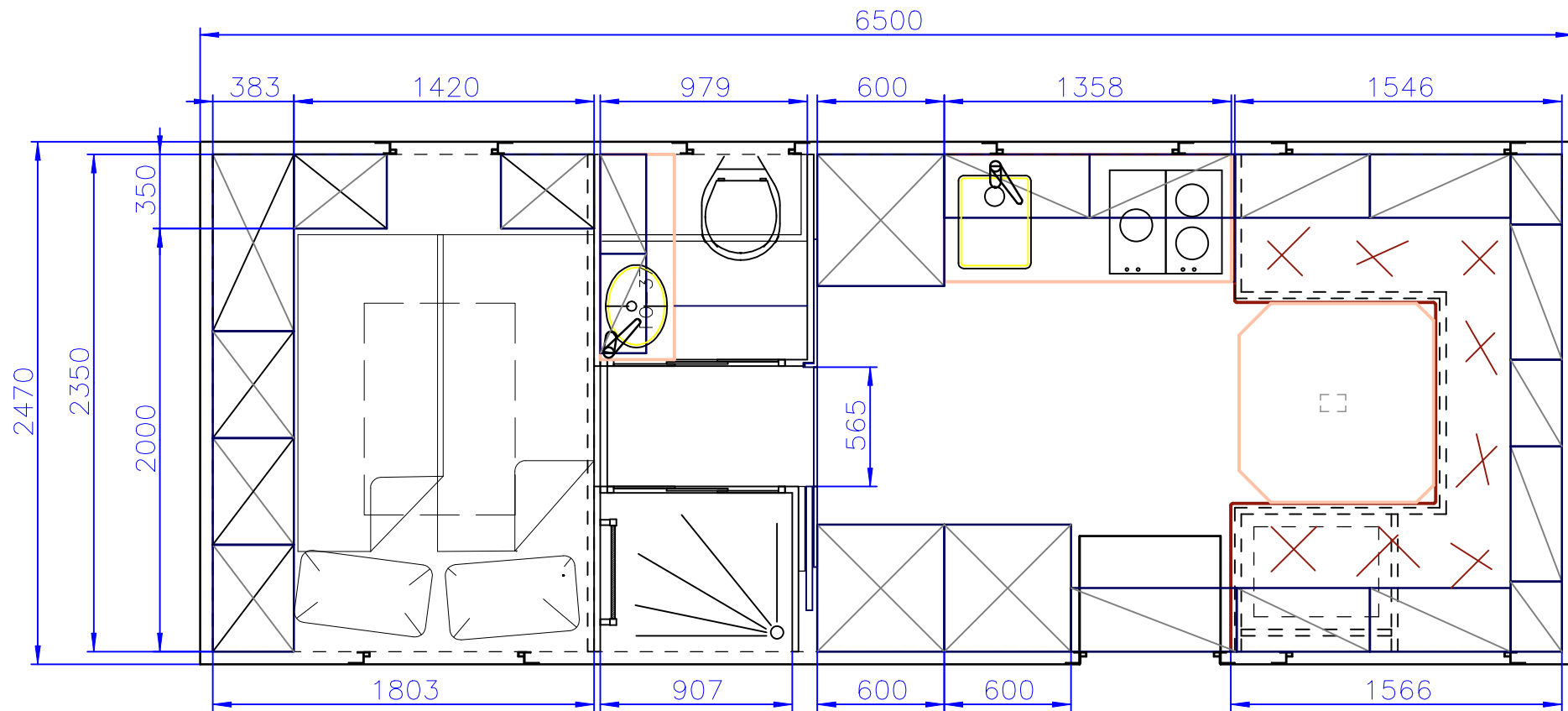

| | | | | | |
|---------|--------|----------------|--------------------|------|--|
| Projekt | | | GLOBECRUISER 6500 | | |
| Bauteil | | | Kabinenausstattung | | |
| Ansicht | | | Grundriß | | |
| Maßstab | Index: | 0 (11.08.2008) | | Pos. | |
| 1:30 | | | | S2 | |

| General information | | | |
|------------------------------|-------------------|-------------------------------|--------------------------|
| VIN-code | XLER6X60005221701 | Factory warranty ,valid until | 2010-09-15 |
| Delivery Date | 2009-09-15 | Invoicing date | 2008-12-15 |
| Assembly date | 2008-11-11 | Current distributor, country | FR |
| Original distributor, number | 61022 | Local dealer, number | |
| Current distributor, number | 61022 | Vehicle type | Tractor with semitrailer |
| Bodywork | Box/vanbody | Operation | Long distance |
| Gross weight | 29 | Order Number | 0477432 |
| Order type | S | Delivery mode | CBU |
| Status | To enduser | POP-ID | |
| Extended commitment | | Extended coverage, valid from | |
| Extended coverage, valid to | | | |

| 00 General | | | |
|---------------------------------|---------------------|---------------------------------|----------|
| Assembly level | Completely Build Up | Product class | Truck |
| Development level | 5 | Wheel configuration | 6x6 |
| Front-wheel drive | Yes | Axle distance | 4255 mm |
| Steering wheel position | LHD, left hand | Chassis width | 2600 mm |
| Chassis adaptation | B, Basic | Truck model | R |
| Type of transport | C | Duty class | H |
| Chassis height | H, high | Operator ´s manual language | French |
| Operator ´s man extra language | Without | Plate language | French |
| Axle weight front,technical | 8500 kg | Bogie weight, technical | 26000 kg |
| Technical total weight | 34500 kg | Technical max axle weight 1st | 8500 kg |
| Technical weight on 2nd axle | 13000 kg | Technical weight on 3rd axle | 13000 kg |
| Legal max axle weight, 1st axle | 7100 kg | Legal max axle weight, 2nd axle | 10500 kg |
| Legal max axle weight, 3rd axle | 10500 kg | Legal, Gross vehicle weight | 26000 kg |
| Legal, Gross train weight | 29500 kg | Preparation for toll collect | Without |

| 01 Engine | | | |
|-------------------------------|--------------------------|-------------------------------|-----------------|
| Engine stroke volume | 12 | Engine type, vehicle | DT12 12 /420 hk |
| Engine type symbol | DT12 12 L01 | Serial. no current | 6410132 |
| Serial. no original | 6410132 | EGR system | With |
| EGR cooling | 1-step | Emission level | Euro 4 |
| Engine management system | S6 | NOx control | With |
| Torque reduction NOx-control | With | Power take-off, engine, prep. | With |
| PTO ED electrical preparation | Without | PTO ED Control | Without |
| Air intake | Rear, high | Air cleaner safety filter | Without |
| Noise dampening | 82 dBA acc to 70/157/EEC | Noise encapsulation engine | Without |
| Crankcase ventilation, type | Open | Crankcase vent. antifreeze | Without |
| Oil level sensor engine | Without | Oil sump material | Aluminium |

| 02 Cooling System | | | |
|-------------------------|----------|-----------------------|--------|
| Fan control unit | Electric | Fan, diameter | 750 mm |
| Fan, gear ratio | 1:1 | Fan blade quantity | 11 |
| Coolant temp high level | 105 C | Temperature regulator | 83° |

| 03 Fuel And Exhaust Systems | | | |
|-----------------------------|--------|------------------|-----|
| Fuel | Diesel | Injection system | HPI |

| | | | |
|------------------------------------|-----------------|--------------------------------------|---------------------|
| Fuel tank | Right hand side | Fuel volume, right side | 300 litres |
| Fuel volume, left side | Without | Fuel tank sectional area | Normal |
| Fuel tank material | Steel | Selective Catalytic Reduction | Without |
| AdBlue tank | Without | Fuel heater | Without |
| Fuel tank location | Normal | Fuel tank filler cap | Without safety vent |
| Fuel filter chassis mounted | Without | Exhaust outlet, direction | Backwards |
| Exhaust silencer execution | Cylindrical | Exhaust silencer heat cover | Normal |
| Particle trap (PMFC) | Without | | |

04 Clutch

| | | | |
|--------------------------------|---------|-------------------------------|---------|
| Clutch, frictiontype | K432 20 | Clutch wear protection | Without |
| Clutch overload warning | Without | Torque converter | Without |

05 Gearbox

| | | | |
|---|----------------|-------------------------------------|--------------------------|
| Gearbox | GRS905R | Serial. no current | 1029134 |
| Serial. no original | 1029134 | Opticruise | With |
| Overdrive | Without | Ecocruise | Without |
| Acceleration control | Without | Kick down signal | With |
| Gear shift ctrl electronic | Opticruise | Gearbox type | GRS with range and split |
| Gear selector position | Steering wheel | Transmission sensor constant | 8,897 |
| Oil cooling for gearbox | Without | PTO EG side | Without |
| PTO EG number of conn. side | Without | PTO EG rear | EG650P |
| PTO EG number of conn. rear | 1 | PTO EG number of connections | 1 |
| PTO EG electrical preparation | Without | EG-power take off | With |
| Power take-off, for clutc connection | Without | PTO EG Control | With conditions |
| Power take-off gear independ. | Without | Transfer gear case | GT900 |
| PTO transfer case el. prep. | Without | PTO split shaft el. prep. | Without |
| Folding gear lever | With | Noise encapsulation gearbox | Without |

06 Propeller Shaft

| | | | |
|---|----------|--|---------|
| Propeller shaft type | P642 | Propeller shaft | 630 mm |
| Prop shaft, intermediate qty. | 0 pieces | Tube length propeller shaft 2 | 0 mm |
| Propshaft length transfer gear - fr. axle gear | 1040 mm | Prop shaft length between front axles | Without |
| Bogie propeller shaft | P520 | | |

07 Front Axle

| | | | |
|---------------------------|---------|----------------------------|---------|
| Front axle, type | AMD901 | Axle gear first | RP736 |
| Serial. no current | 2011995 | Serial. no original | 2011995 |
| Front axle ratio | 4,24 | | |

08 Rear Axle

| | | | |
|-----------------------------|---------|-----------------------------|---------|
| Rear axle, type | AD1501P | Oil filter rear axle | With |
| Axle gear first | RBP835 | Serial. no current | 1053147 |
| Serial. no original | 1053147 | Axle gear second | RP835 |
| Serial. no current | 1052610 | Serial. no original | 1052610 |
| Rear axle gear ratio | 4,27 | Differential lock | With |
| Hub reduction, rear | With | Tag axle preparation | Without |

09 Hubs And Wheels

| | | | |
|--|-----------------|--|-----------------|
| Wheel, type | Disc | Rim material | Steel |
| Rim diameter front axle | 20" | Rim diameter rear axle | 20" |
| Rim diameter spare wheel | 20" | Rim width front axle | 10.00 V |
| Rim width rear axle | 10.00 V | Rim width spare wheel | 10.00 V |
| Tyre dimension front axle | 14.00 R 20 | Tyre dimension rear axle | 14.00 R 20 |
| Tyre dimension spare wheel | 14.00 R 20 | Tyre calc. roll. radius front | Group A= 595 mm |
| Tyre calc. roll. radius drive | Group A= 595 mm | Tyre rolling circumference driving axle | 3828 mm |
| Front axle tyre rolling circumference | 3776 mm | Drive tyre rolling circumferenc | 3776 mm |
| Tyre supplier front axle | Michelin | Tyre supplier rear axle | Michelin |
| Tyre supplier spare wheel | Michelin | Tyre, pattern front axle | XZL |
| Tyre, pattern rear axle | XZL | Tyre, pattern spare wheel | XZL Michelin |
| Tyre load index front axle | 160 | Tyre load index rear axle | 160 |
| Tyre load index spare wheel | 160 | Tyre pressure monitoring | Without |

10 Brakes

| | | | |
|---------------------------------------|----------------------|---------------------------------------|--------------------|
| White smoke limiter | With | Wheel brake | Drum |
| Brake control | Pneumatic | Hill hold | Without |
| Brake category | AB | Adjustm, brake slack adjuster | Automatic |
| Brake shoe width, front axle | 203 mm (8") | Brake shoe width, rear axle | 254 mm (10") |
| Brake chamber type 1st front | Membrane+spring | Brake chamber area, 1st front | 24 in ² |
| Brake chamber type, 1st rear | Membrane+spring | Brake chamber area 1st rear | 24 in ² |
| Brake chamber type, 2nd rear | Membrane+spring | Brake chamber area, 2nd rear | 24 in ² |
| Brake shoe make | MM Scania MM | Anti vibr.set in brake chamber | Without |
| Traction control | With | ABS, Anti-lock brakes | With |
| ABS/EBS system | 6S/6M | Brake management system | ABS_E |
| Air Processing System | Air management | Compressor manufacture | Knorr 600 |
| Interlock valve, parking brake | Without | Load sensing | With |
| Trailer brake connection | Without | Trailer connector bracket | Without |
| Trailer brake coupling | Without | Exhaust brake | With |
| Exhaust brake control | Manual and automatic | Retarder | Scania |
| Retarder system | RETscania1 | Disengaging parking brake fr. | Without |

11 Frame

| | | | |
|---|---------------|---------------------------------------|-------------------------|
| Frame, type | F958 | Frame material, yield strength | 500 N / mm ² |
| Chassis colour | Sub grey | Chassis front end width | 1020 mm |
| Chassis front end width | 1020 mm | Dimension JE | 2170 mm |
| Hole pattern for bodywork | Basic pattern | Frame, side member rear end | V |
| Tow beam | Without | Bumper protruding | With |
| FUP directive | Without | FUP additional beam | Without |
| Underrun protection Argentina regulation | Without | Lateral protection | Without |

12 Suspension

| | | | |
|---------------------------------------|------------|---------------------------------------|------------------|
| Suspension system, front | Leaf | Leaf suspension type front | Parabolic |
| Suspension front, leaf springs | 3x29 | Shock abs 1st fr ax heavy duty | With |
| Shock absorber pos 1st fr axle | Forward | Suspension system rear | Leaf |
| Leaf suspension type rear | Multi leaf | Suspension rear, leaf springs | 12x20/90 |
| Bogie type | BT300I | Bogie distance | 1445 mm |
| Anti-roll bar type front | Solid | Anti-roll bar, front | Normal stiffness |

| | | | |
|---------------------------------|------|--|--|
| Anti-roll bar, rear axle | With | | |
|---------------------------------|------|--|--|

13 Steering

| | | | |
|---------------------------------------|---------|----------------------------------|-----------|
| Power steering gear | TAS 86 | Serial. no current | 500719 |
| Steering gear ratio | 18,6:1 | Steering system | 2-circuit |
| Steering force 70/311 92/62EEC | Yes | Air bag in steering wheel | Without |
| Steering wheel type | Normal | Adjustable steering wheel | With |
| Alco lock | Without | Immobiliser | With |

14 Engine Controls

| | | | |
|-------------------------------------|---------|---------------------------|---------|
| Speed limiter | With | Speed limitation | 85 km/h |
| Speed limiter second, switch | Without | Speed limit second | Without |
| Speed limiter third | Without | | |

16 Electrical System

| | | | |
|--|-------------------------------|--------------------------------------|---------------------|
| Alternator charge | 100 A | Battery | 180 Ah |
| Battery box execution | 140Ah-180Ah | Battery master switch | Service |
| Batt master switch maneuvering | Double acting left side frame | Headlamp type | H4 |
| Headlamp asymmetry | Right hand | Visibility system environment | 2 |
| Head lamp protection | With | Headlamp cleaning | Without |
| Headlamp high located | Without | Headlamp levelling | Without |
| Taillamp position | On bracket | Taillamp type | 7-chambers |
| Taillamp cable length | Without extension | Side marker lamps | Temporarily mounted |
| Spot lamp in ext. sun visor | With | Spot lamp in bumper | Without |
| Daytime running light | Without | End outline marker lamp | White |
| Reflector rear acc to ECE-R70 | Without | Fog lamp front | Without |
| Foglamp, rear | With | Reversing light | With |
| Work lamp | Without | Beacon | Without |
| Horn | Compressed air | Reverse alarm | Without |
| Brake pressure lamp test | Without | Trailer electric connector | Without |
| Electric engine heater | Without | ADR vehicle designation | Without |
| Electric cables ADR type | Without | Electrical components ground | Chassis grounded |
| Distance sensor System | Without | BWS (body work system) | Without |
| Remote contr engine start | Without | Cable harness for taillift | Without |
| Cable harness additional switches | Without | Cable harness for bodybuilder | Without |
| Cable h for bodybuilder frame | Without | Cable h for bodybuilder roof | Without |
| Battery connection bodybuilder | Without | | |

17 Instruments

| | | | |
|--|--------------------|--------------------------------|-------------|
| Tachograph | Digital STONERIDGE | Instrument cluster | Basic km/h |
| Cruise control switches | Steering wheel | Adaptive Cruise control | Without |
| Language data file SW | Multiple languages | Instrument panel | Long curved |
| Instrument panel passenger side | With lid | Bodywork info in ICL | Without |

18 Cab

| | | | |
|---------------------------|---------|------------------------------|---------|
| Cab type | CR | Cab length | 19 dm |
| Roof height | Normal | Cab, special adaption | Without |
| Serial. no current | 5221701 | Serial. no original | 5221701 |

| | | | |
|---------------------------------------|------------------------|---|-----------------------------|
| Cab colour | White Ivory | Clear varnish | Without |
| Grille colour | Grey, 1537563 | Boarding step front, foldable | Without |
| Ladder | Without | Windscreen | Untinted |
| Window, rear wall, cab | Without | Window side | Without |
| Door window | Single glass | Window winder door | Electrical driver+pass.side |
| Interior side sun visor | Drivers side | Door panel | Textile |
| Air conditioning | With | Auxiliary heating | Without |
| Climate system control | Automatic | HVAC system configuration | Edition 2 |
| Cab socket 230V | Without | Cab suspension | 4-point air sprunged |
| Cab tilting | Mechanical | Roof hatch | Manual |
| Mosquito net in roof | Without | Central locking and alarm | Manual c-lock |
| Number of keys/remotes | Two | Roof rail | Without |
| Roof rack | Without | Air deflector | Without |
| Extended side air deflector | Without | Arm rest driver | Without |
| Seat category, driver side | Medium | Adjustable shock absorber driver side | With |
| Upholstery seat driver | Velour | Heating pad driver | Without |
| Seating equipment, passenger | Seat | Seat category, passenger side | Medium |
| Arm rest passenger | Without | Adjustable shock absorber passenger side | Without |
| Upholstery seat passenger | Velour | Heating pad passenger | Without |
| Bed | Lower | Passenger bench | Without |
| Bed safety net | With | Radio | Preparation (12V) |
| Information switch | Steering wheel | Radio communication FFU | Prepared |
| Mobile telephone preparation | Without | 12V socket in dashboard | With |
| CB radio | Prepared | Horn, compressed air | Without |
| Splash guard, front | With | Front mudguard, execution | Split |
| Bulk cargo fenders, front | Without | Mudguard rear | Without |
| Spray-suppress. acc 91/226/EEC | No | Wheel housing | Large |
| Warning signal uncon.seat belt | Lamp and audio signals | Red coloured seat belts | Without |
| Seat belt pretensioner | Without | Mirror type | With air deflector |
| Frontview mirror | With | Rear view mirrors, heated | With |
| Rear view mirror type driver | Spherical EC2003/97 | Rear view mirror, passenger | Spherical EC2003/97 |
| Electric mirror adjustment | Pass+driver side | Close up mirror | With |
| Wide angle mirror | Driver+passenger side | External storage compartment | Without |
| Storage bins doors | With | Rear wall storage | Without |

19 Complementary Equipment

| | | | |
|-------------------------------------|---------------|---------------------------------------|---------|
| Fifth wheel | Without | Bracket front mounted equip. | Without |
| ACL aut. chassis lubrication | Without | Drawbeam | With |
| Drawbeam type | Under mounted | Dimension JA/BEP L020 | 2510 mm |
| Trailer coupling | Without | Trailer electric connector | Without |
| Side skirts | Without | Rescue equip. except fire ext. | Normal |
| Hose for tyre inflation | Without | Spare wheel carrier | Without |
| Fire extinguisher | Without | | |

20 Load Carrying Bodywork

| | | | |
|-------------------------------------|---------|---|---------|
| Body adaptation | Without | Tipper body control valve, preparation | Without |
| Bracket for tipper front ram | Without | Tail lift | Without |
| Towing jaw | Without | Exchange body vehicle | No |
| Refuse packer step | Without | | |

SOPS file and modifications

| | | | | | |
|----------------------------|--|---------------------|--------|-----------------------------------|------------|
| SOPS status | Available for modification | SOPS version | 11 | Creation date of SOPS file | 2014-01-30 |
| S-order number | 456280 | FFU-number | 356613 | | |
| Local modifications | Tachograph: Without Tachograph system: Without Drive tyre rolling circumferenc: 3620 mm Front axle tyre rolling circumference: 3620 mm Tachograph: Without | | | | |

Certificate

| | | | |
|--|---|--|---|
| Air tanks 04-202-028 | Air tanks 04-202-029 | Air tanks 12 202 03 12 9006 028 | Air tanks LR 0057/2 |
| Air tanks LR 0057/4 | Anti-theft e4*74/61*95/56*0211*02 | Brakes E4-13R-100818 EXT.02 | Brakes e4*71/320*2002/78*1741*06 |
| Cab strength E4-29RC-020015 EXT.00 | Cab strength E4-29RC-020017 EXT.00 | Cab strength T071FH EXT.12 | Cab strength T129FH |
| Coupling devices e4*94/20*94/20*1249*08 | EMC e4*72/245*2006/28*0820*08 | Emission e4*2005/55*2006/81C*0093*00 | External projections e4*92/114*92/114*0039*07 |
| Fuel tanks e4*70/221*2006/20*0417*08 | Heating system e4*2001/56*2006/119*0092*12 | Noise e4*70/157*1999/101*1553*02 | Noise e4*70/157*1999/101*1553*03 |
| Noise e4*70/157*2007/34*1848*02 | Noise e4*70/157*2007/34*1891*00 | Power e4*80/1269*1999/99*1124*00 | Rear underrun protection e4*70/221*2000/8*0410*03 |
| Rear view mirrors e4*2003/97*2005/27*2500*01 | Registration plate space e4*70/222*70/222*0135*01 | Safety belt anchorages e4*76/115*2005/41*0228*07 | Safety belts e4*77/541*2005/40*0176*05 |
| Safety glazing e4*92/22*2001/92*0120*02 | Seats e4*74/408*2005/39*0216*07 | Signal horn E4-28R-000094 EXT.02 | Signal horn e4*70/388*87/354*0141*02 |
| Smoke e4*72/306*2005/21*0737*00 | Speedlimiter e4*92/94*92/94*0073*01 | Speedometer E4-39R-000085 EXT.03 | Speedometer e4*75/443*97/39*0170*09 |
| Steering e4*70/311*1999/7*0303*06 | Steering e4*70/311*1999/7*0322*02 | Symbols e4*78/316*94/53*0140*02 | Tachograph -e5-0002- |
| Towing devices e4*77/389*96/64*0137*03 | Type plate e4*76/114*87/354*0151*03 | Tyres e4*92/23*2005/11*0131*11 | |

Torsionfree subframe, double 3 points for 6x6

Manual tire inflation system (6x6)

Installation of 1 adjustable central pressure regulator and 6 flexible hoses with quick connectors to be connected to the tires while vehicle is parked.

Fuel Tank system 680 Litres

ACTION MOBIL cabin shell.

exterior dimensions: 6.500 x 2.470mm. Interior height: 1.950mm (1.900mm with underfloor heating). Walls and roof panels fiberglass panels, skin polyester reinforced. Panel sandwich 61mm, inside skin 2mm, outside skin 3mm, additionally reinforced. 55mm insulation foam, density 50kg/m³. K:0,37/m³/h/°C. Floor plate 105 mm, reinforced with square section steel tubes.

Inclination

of body side walls. Reduction of width of body in roof area of about 15 cm.

ACTION MOBIL entrance in two parts

ACTION MOBIL entrance in two parts with additional, upward-opening flap. With integrated steps out of GF-sandwich panels.

PVC double lip seal. Double GF section. 3-point locking by means of solid lever bolt. Top quality security cylinder lock with integrated dust protection in one key system with security certificate. In addition the lock is equipped with a dust protection flap. All fittings made of stainless steel V2A.

Electrically operated step (2-step)

mounted under the stairway box. Switch beside the door inside the body. Connected to the electrical system of the body. Removable for serious off-road activities with water-proof plug.

ACTION MOBIL roof exit hatch

ACTION MOBIL roof exit flap made of glass fiber reinforced plastic sandwich, incl. Mosquito net. No cold bridge, highly insulated and accessible. Size: about 1 m².

Hinged ACTION MOBIL-window with safety-glass. Size 450x450mm

double-glazed window unit with no cold bridge, outer and inner frame made of fiberglass profile.

2 layers of safety glass 6mm each with 8 mm vacuum void. Hinges and locks made of stainless-steel, fixed with stainless steel bolts. Secure ventilation setting.

2 manual locks to open, close and lock the window.

Flush mounted design.

Opening angle appr. 90°.

Hinged ACTION MOBIL-window with safety-glass. Size 800x450mm
double-glazed window unit with no cold bridge, outer and inner frame made of fiberglass profile.

2 layers of safety glass 6mm each with 8 mm vacuum void. Hinges and locks made of stainless-steel, fixed with stainless steel bolts. Secure ventilation setting.

2 manual locks to open, close and lock the window.

Flush mounted design.

Opening angle appr. 80°.

Hinged ACTION MOBIL-window with safety-glass. Size 1.000x450mm

Hinged ACTION MOBIL-window with safety-glass. Size 700x450mm

Moskitonet/blind - upcharge

special top-quality moskitonet/blind in a frame made of painted aluminium.

Roof-Vent

24V, performance max. 850m³/h, for aerate and de-aerate, infinitely variable Speed,

bathroom ventilator hatch

low profile smoke grey acrylic roof hatch in aluminium frame with adjustable hatch stays and secure ventilator catches. Size: 420x420mm

fly screen

for roof hatch made to measure with demountable fixings. 420x420mm

U-shaped seating area 1.600x2.350mm

Covering of space underneath table with reinforced waterproof woodplates. Incl. Lids to use space under raised mounted seating area. Incl. Reinforcements as preparation to mount the table leg.

Upholstery U-shaped seating area 1.600x2.350mm

Upholstery for seating area. Storage compartment under left seat bench with lift-up lid. lids and blinds made of plywood with bandings. (Selection of colours and surfaces upon customers choice.) Backrest removable to convert seating area into a bed.

Table, lowerable, size ca. 800 x 600 mm

Table board with cutted and rounded corners.

Mounted on lowerable electric table rack. Ledges on bench seat.

Made of 2 side laminated block plywood with real wood bandings.

(Selection of colours and surfaces upon customers choice.)

Hanger cupboard, size : 1500 mm

with 3 flap doors. With automatic stays, pneumatic bumpers and off road catches. Carcass made of 2 side furniture-grade laminated plywood. Edges covered with bandings of real wood or plastics as required. (Selection of colours and surfaces to customers choice.)

Hanger cupboard, size : 1800 mm
with 4 flap doors. With automatic stays, pneumatic bumpers and off road catches. Carcass made of 2 side furniture-grade laminated plywood. Edges covered with bandings of real wood or plastics as required.(Selection of colours and surfaces to customers choice.)

Sliding door
made of 2 side laminated block plywood with real wood bandings.To separate the living-area from the bedroom.

Hanger cupboard, size : 2000 mm
with 4 flap doors. With automatic stays, pneumatic bumpers and off road catches. Carcass made of 2 side furniture-grade laminated plywood. Edges covered with bandings of real wood or plastics as required.(Selection of colours and surfaces to customers choice.)

Mattress 2.000x700mm
Comfort-mattress with removable cover.

Wood mattress suspension 2.000x700mm
Mattress suspension with manually liftable head rest and footrest.

Küchenblock, Maße 1400 x 650 (mm)

3-flame cooktop
3-flame stainless steel gas stove, mounted in kitchen.

full gas installation
with supply pipes as required. 3 control valves. Additional push-connector for exterior use. All materials and mounting off road proof. Fully inspected with gas certificate.

Mounting for gas bottles
in ventilated secure locker.
Barrel lock keyed to pass.

Washing machine with integrated dryer
MIELE. Capacity: washing 5 kg, drying, 2,5 kg. Consumption: 65 litres, 3,4 kWh

Dishwasher
Dometic Dishwasher for 6 place settings. Water consumption normal: 7 ltrs. Colour: silver.

Oven combined with microwave. MIELE.

custom fitting of kitchen storage
design and installation of tailor made off-road fittings to hold customers own cooking equipment, cutlery, china, glasses etc. typical 4 person place settings.

Stainless steel work top with sink(surcharge)
one piece preformed STAINLESS STEEL work top, made to measure with profiled upstands and nosings.

Integrated stainless steel sink and.

Hanger cupboard, size : 1400 mm

with 3 flap doors. With automatic stays, pneumatic bumpers and off road catches. Carcass made of 2 side furniture-grade laminated plywood. Edges covered with bandings of real wood or plastics as required.(Selection of colours and surfaces to customers choice.)

fully fitted wardrobe.

custom built fully fitted wardrobe with hanging rails, shelves and 2 drawers.

Carcass made of 2 side furniture-grade laminated plywood. All drawers with stainless steel runners, automatic closers and off-road catches. Edges covered with bandings of real wood or plastics as required.

(Selection of colours and surfaces to customers choice.)

purpose built fridge/kitchen storage unit.

built to accommodate fridge with 2 drawers below fridge and one storage cupboard above.

Carcass made of 2 side furniture-grade laminated plywood. All drawers with stainless steel runners, automatic closers and off-road catches. Edges covered with bandings of real wood or plastics as required.

(Selection of colours and surfaces to customers choice.)

Document safe

secure fire-proof lockable steel document safe.

custom built control panel

black anodized aluminium panel with layout graphics in 2 side furniture-grade laminated plywood frame.

Automatic closing catch and Blum-hinges.

Floor covering synthetic special (per sqm)

Bonded to walking area and floor of seat pedestal, proofed with silicon sealing compound.

(Selection of colours and surfaces upon customers choice.)

Toughened clear glass shower door.

Incl. Chrome hinges and fittings as required.

bathroom storage/vanity cabinet

2 doors both internally mirrored. 2 adjustable shelves per side with built-in fiddle rail. Carcass made of 2 side furniture-grade laminated plywood. Edges covered with bandings of real wood or plastics as required.(Selection of colours and surfaces to customers choice.)

Floor in shower of TEAK

Surcharge for TEAK in the shower-area.

Generator 6 Ultra 1500 upm

Completely covered and sound isolated diesel generator, 5,7 KW, 3-cylinders, 952 rpm. Separated cooling systems for engine- and generator-part. Starterbattery 12V/70Ah. Exhaustsystem with pre- and main-silencer. Incl. Controlpanel and main battery-switch. additional steelplate to reduce vibration.

Battery charger 12V 10 A - 115/230V

I-U battery-charger, input 90 - 265 V AC, 45 - 65 Hz. Output 12V 10 A. Incl. Additional circuit breaker

Stand-by inverter/charger.

24VDC to 12VDC to charge the battery of the generator from the main 24V DC battery package. Battery charge constantly maintained even when battery is out of use for long periods.

Battery monitoring system 12/24V DC.

Monitors all battery parameters: residual charge, hourly consumption and running time. Optimizes the use of electrical energy.

Shunt

required to monitor/optimize battery performance.

Batterie AGM 12V 260Ah

Batterie AGM 12V 260Ah. Maintenance free.

total capacity: 780Ah/24V

Battery plate protection system

increases battery life by a factor of 3-5 by minimizing sulfating.

Charging from alternator

System to optimize charging of house batteries from engine alternator. Charge is regulated via a diode to enable a complete full charge.

Inverter and battery charger 24V DC - 230V AC, 3kW

Installation of a combined DC - AC inverter and battery charger with voltage and temperature sensing. Continuous output: 3000 watts max. output: 6000 watts charging output: 70 A

Stand-by inverter.

24VDC to 12VDC inverter to provide the 12VDC consumers from the main 24V DC battery package.

Solar panel 240W 24V - Installation first panel

Supply of the solar panel 240W -24V

Wiring from solar charger to the roof

Drill the roof and installation of a connexion box - sealing of the hole

Installation of the solar panel with special bracket glue on the roof

Connexion of the solar panel

Performance: 960 Watt peak

Solar charging regulator.

80A. Protection/regulation system to prevent overcharging of house batteries. Special MPPT technology for high-efficiency output.

Compressor for Fridge

Fully hermetic compressor with control electronics and integrated low-voltage protection. Automatic cut-in at normal voltage. O-vaporator, consumption: 60 watts. Temperature adjustment by means of an internal thermostat. Evaporator cell with extractable drip collection tray.

made of 60mm sandwich panels. Insulated door and magnetic gasket included.

Compressor for Freezer

Body for Freezer

made of 90mm sandwich panels. Insulated door and magnetic sealing included.

external digital thermostat and control system
mounted on the main control panel (surcharge)

FM/AM-Tuner with CD-drive

plays both normal CD and MP3 format. Incl. two 2-way built-in speakers as per mounting-space available. Flexible, detachable top antenna with amplifier, mounted with dissipator on the roof.

LCD TV Samsung SyncMaster 242MP 24.1 Zoll

Satellite TV receiving system

Satellite TV receiving system consisting of a satellite receiver, automatic self-aligning and self-adjusting antenna and control panel, connecting cable. Incl. assembly and electrical installations.

Aircondition Telair 7000

Aircondition, splitted with compressor/evaporator unit mounted at the bottom of the body of optimized center of gravity. Low-designed evaporator mounted on the roof of the body. Refrigerating yield: 2.1 kW (7.200 BTU). Integrated heater 1.000 W.

reversing camera 6" color monitor.

Central light switch

Shuts off and on all lights in the body.
Mounted in the entrance area.

Xelogen flex arm reading light 10W

Metal casing, pivoting and swivelling.

Xelogen lamp 28V 10W.

Integrated rocker switch.

wires installed inside covered cable tubes, connected to electrical system of body.

Work light Hella LED

Hella work light, mounted on the roof rack, left and right side and one on rear wall of the body

Alarmsystem

central unit with narcotic gas sensor installed in sleeping room nearby head. Incl. Ultrasonic sensor for both body and driver's cab. Incl. Door contact switches for ACTION MOBIL luggage compartment hatches.

LPG-gas detector

connected to the alarmsystem. Installed in the floor area of the cabin. Includes wiring to the built-in alarmsystem and mechanical protection.

Carbon monoxyd detector

connected to the alarmsystem. Installed in the sleeping area. Includes wiring to the built-in alarmsystem.

Freshwater tank

main cabin water pump

SEAGULL X2B water purification system

exterior shower

Sealand toilet system with porcelain toilet bowl.

Blackwater tank, capacity 63 liters

Toilet brush

Toilet paper rack

Vacuum blower for black water tank

Installation of a vacuum blower in the vent line of the black water tank.

3" hose for dumping of grey and black water

Flexible hose with quick coupling, stored in a tube under the body.

Greywater tank 190 liters

5 KW Webasto Diesel heater

Bathroom radiator.

Sleeping room radiator

Floor heating system

Electrical heater for central heating system, 230V AC, 2 kW

heat exchanger TGS/TGM

anti freeze protection for greywater tank

Installation of copper tubes into the tank. Connected to the domestic heating system.

macerator pump

24V DC. Installed between grey and black water tank. Flushes waste grey water through black water tank.

off road mounting bracket for spare wheel (with tyre)

Telescopic ladder, extended length 330 cm

universal use, off-road prove mounting in rear storage compartment

Jerry can holder for 2 x 20 liter

Made of steel, painted black. Mounted under the body.

Prepared to be locked by a separate lock.

Fire defense set, consisting of:

1 x CO2 fire extinguisher, 2kg, 1 x powder extinguisher 6kg, 1 x fire blanket 100x100cm.

Mounted in the body or in driver's cab

protection rails

for cabin. Tailor made as required, 54mm stainless steel, brushed finish.

ACTION MOBIL motorcycle lift.

ACTION MOBIL motorcycle lift. Made of solid steel, galvanized and painted in body colour.

Designed to transport 1 motorcycle (max 200kg.)

in rugged terrain. Mounted on the reinforced tail end of the ACTION MOBIL cabin. Raised and lowered by means of an electric powered hydraulic system with 1 cylinder. Convenient and fast handling. Motor cycle deck can also be used to transport various items (heavy stowage boxes, sand ladders, additional spare wheels, etc.). Especially designed for bodies with rear slope.