

# ACTION MOBIL

# PDF JOURNAL

# 1 / 2009

EXPEDITIONSMOBILE / ALL WHEEL MOTORHOMES / VÉHICULES D'EXPEDITION / [www.actionmobil.com](http://www.actionmobil.com)



This journal informs about important topics, innovations and events about

**ACTION MOBIL  
BUILT IN AUSTRIA -DRIVEN  
IN THE WORLD!**

**“GLOBECRUISER”**

*...elegant  
living-room  
ambience,  
constructed for  
rough off-road  
terrain!*

The ACTION MOBIL series “GLOBECRUISER” has garnered international attention. Featuring photos and text, the Internet posted the news around the world (see the list of links on our homepage/ Products/ Globecruiser). In fact this series of motor homes is designed for long-distance travels and leaves nothing to be desired. The equipment corresponds to that of a modern bungalow. The big difference, however, is that the owner of such a vehicle has his own home with him at all times and wherever in the world he may be – in the centre of a city, in remote deserts or in tropical jungle. Every ACTION MOBIL is tailored to the client’s individual requirements.



Modell GLOBECRUISER:

Interior equipment designed for 2 persons.



Modell GLOBECRUISER-family:

Interior equipment designed for 4 persons.

IMPRESSUM - COPYRIGHT:  
ACTION MOBIL GmbH&Co.KG  
A 5760 SAALFELDEN-Österreich.  
Tel. +43 6582-72712 0  
Fax. +43 6582-72712 9



Going off-road with 530 HP without foregoing any convenience in the living area!

Even though such a vehicle resembles a genuine all-wheel truck from outside, it does not mean that it is not smooth and cosy inside.

The ACTION MOBIL series is a spectacular interpretation of vehicles for touring the globe. The interior is equipped with materials of first-rate quality.

In the concrete model the layout is designed for 2 persons, whereas in the version "family" it is designed for 4 persons. Modifications of the interior equipment are possible.

# ACTION MOBIL

SERIES:  
GLOBECRUISER

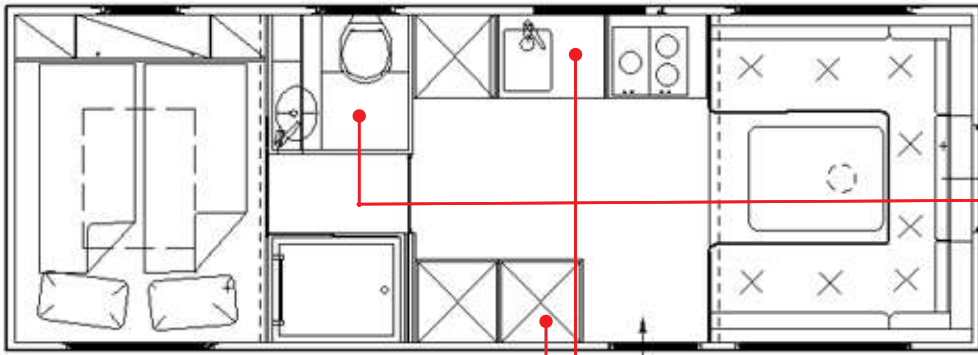

The living area is separated from the sanitary area by a sliding door.

The sitting area can be converted into beds, if required.



**ACTION MOBIL – TURNING ADVENTURE INTO PLEASURE!**

# GLOBECRUISER *family*



# NEWS



The ACTION MOBIL type GLOBECRUISER "family" is being tested before setting out on an 8 months' tour across Africa.



ACTION MOBIL makes it possible to integrate additional seats in the cabin. For this purpose a folding bench is installed behind the regular seats. Being equipped with headrests and additional seatbelts, the two extra seats are approved by the authorities. The photo shows the extra seats installed in the version "family".



From April 16 to May 1, ACTION MOBIL is again organizing an adventure convoi, which will take us to Libya this time. 8 ACTION MOBIL teams will be taking part in this tour. Our next PDF Journal will feature the itinerary of the convoi.



The first model: "ECONOMY 3" has left the workshop in Austria. For more details we would like to refer you to our next PDF Journal.